

# FLOW METER

## Model E

Variable area flow meter model E is made from clear acrylic. It is available in single-tube and multi-tube versions. Model E is equipped with a flow adjustment valve and is also available in customized designs.



### FEATURES

- Acrylic body
- Flow adjustment valve
- Several flow ranges
- Clear, easy to read scale

### TYPICAL APPLICATIONS

- Water- and air purgings
- Gas measurements
- Liquid measurements

### OPTIONS

- Scale for alternative liquids and gases
- Special scale markings
- Thread adapters
- Multi-tube version
- Viton® or EPDM seals



### Technical data E

<b>Model</b>	<b>EK -</b>	<b>EH -</b>
Weight	170 g	200 g
Valve housing/plugs	Nylon	AISI 316
Valve spindle	AISI 316	
Body	Acrylic (PMMA)	
Seals	Nitrile (*Viton®, EPDM)	
Max. pressure	20 bar (30 bar/30 °C)	
Max. temperature	75 °C	
Connections	BSP 1/4", Thread adapters must be used for NPT-connections	
<b>Accuracy</b>	± 5 % F.S. (H <sub>2</sub> O, +20 °C)	

\*) Special construction on request

E					
				<b>Special feature</b>	
			H	Hand knob in valve	
			V	Viton® -seals	
				<b>Scale</b>	
			A	H <sub>2</sub> O (l/min) at +20°C	
			R	Air (Nl/min) at +20°C / 101,3 kPa	
				<b>Flow range</b>	
				<b>H<sub>2</sub>O</b>	<b>Air</b>
		2K		2 - 16 ml/min	0,1 - 0,8 Nl/min
		2L		2,5 - 30 ml/min	0,1 - 1,2 Nl/min
		2M		5 - 55 ml/min	0,2 - 1,8 Nl/min
		2N		10 - 80 ml/min	0,4 - 2,6 Nl/min
		3K		0,01- 0,11 l/min	0,5 - 5,5 Nl/min
		3L		0,02 - 0,18 l/min	0,5 - 7 Nl/min
		3M		0,025 - 0,3 l/min	1 - 9 Nl/min
		3N		0,05 - 0,45 l/min	1 - 12 Nl/min
		4B		0,05 - 0,5 l/min	2 - 20 Nl/min
		4A		0,1 - 1,1 l/min	2 - 36 Nl/min
		5E		0,2 - 1,6 l/min	7,5 - 47,5 Nl/min
		5S		0,2 - 2,2 l/min	5 - 70 Nl/min
		5F		0,5 - 2,5 l/min	10 - 90 Nl/min
				<b>Valve housing / plug material</b>	
			K	Nylon	
			H	AISI 316	
				<b>Tubes</b>	
				Single tube	
		N		Number of tubes (2-12)	

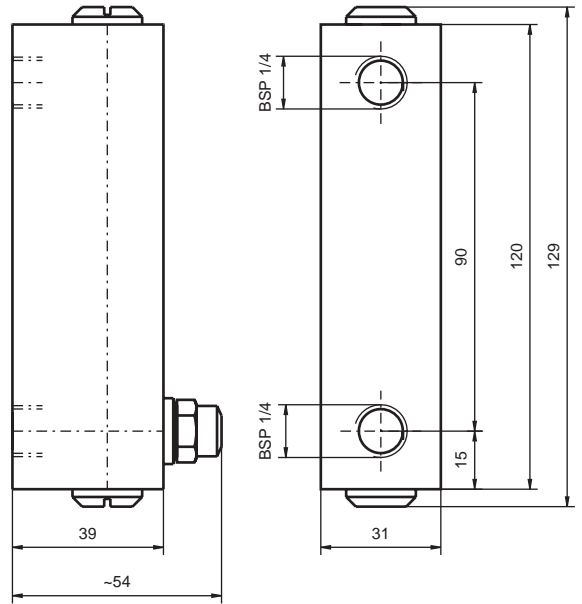

Note, thread adapters must be used for NPT-connections

MANUFACTURER



KYTOLA OY • Olli Kytolan tie 1  
 P.O. Box 5 • FI-40951 MUURAME • FINLAND  
 Phone +358 14 339 0600 • Fax +358 14 631 419  
 E-mail sales@kytola.com • www.kytola.com

LOCAL REPRESENTATIVE